

MICR (E-13B) Font Solution

Installation & Test Guide

For HP LaserJets & MFPs with Compact Flash

TYPEHAUS

Extending the Resources and Abilities of Your Printer

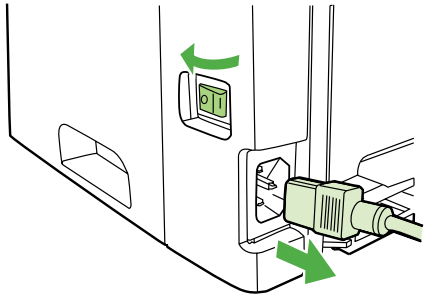

1

Use the power switch to turn off the printer and then unplug the power cord from the printer.

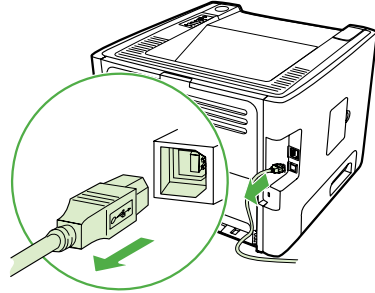

2

Unplug all remaining cables and cords from the printer.

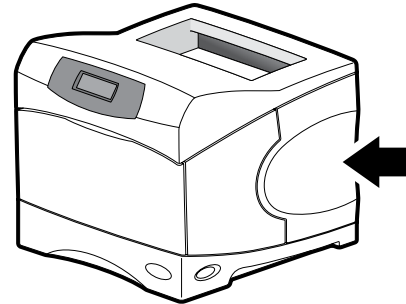

3

Locate the access door located on the side of the printer. The location can vary by model.

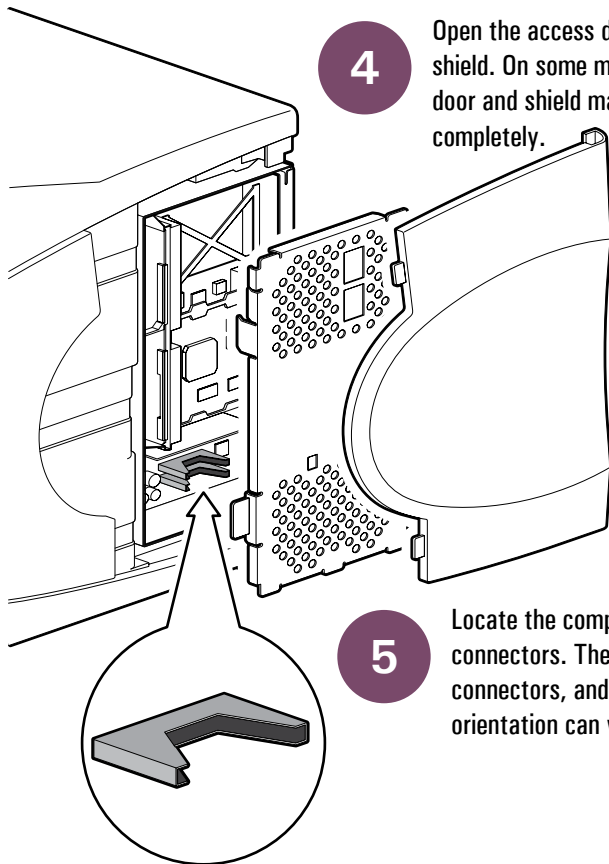

4

Open the access door and metal shield. On some models the door and shield may remove completely.

5

Locate the compact flash (CF) connectors. The number of CF connectors, and the location and orientation can vary by model.

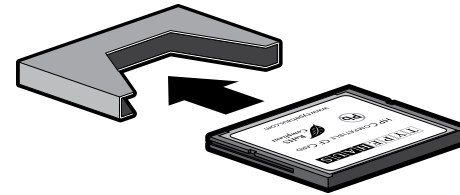

6

Insert the MICR Font Solution into any open CF connector. Do not remove any existing CF cards. The card will only insert in one orientation. If it does not slide easily, rotate it and try again. A very small amount of extra pressure will be necessary at the very end to make sure the card is completely plugged into the short pins at the base of the connector. Never use strong force. Strong force may damage your printer.

7

Close the shield and access door, reconnect all cables and cords, then turn the power switch on.

Congratulations!

You are now ready to print MICR using your printer. To test your MICR Font Solution, simply use your printer's control panel to print a PCL Font List. On most printers, select "Information" and then "Print PCL Font List".

See the reverse side of this sheet for an example of the first page of a PCL Font List showing the MICR Font Solution font. The PCL Font List may vary a little between different printer models, but the MICR font will be shown somewhere in the list.

PCL5 Font Selection

E_c(0Q^Ec(s0p8h8.4v0s0b0T

Character Mapping

MICR	Char	Dec	Hex
0	0	48	30
1	1	49	31
2	2	50	32
3	3	51	33
4	4	52	34
5	5	53	35
6	6	54	36
7	7	55	37
8	8	56	38
9	9	57	39
A	A	65	41
B	B	66	42
C	C	67	43
D	D	68	44

TypeHaus Reorder Part Number: 11B581-36

Solutions
Business Partner



TypeHaus, Inc.
655 Second Street
Encinitas, CA 92024
760.334.3555
www.typehaus.com

© 2010 TypeHaus, Inc. All rights reserved. (2154-100830A)

HP LaserJet Printers PCL Font List



USB STORAGE Resident Fonts

Font	Pitch/Point	Escape Sequence	Font #	Font ID
ABCDEFGHIJj i ç ³ ´ ¶ ¸ ¹ º » ¼ ½ ¾ # \$	10.00/10.0	<esc>(00<esc>(s0p10.00h10.0v0s0b104t	USB1 1	
OCRA				
TH MICR 0Q	8.00/8.4	<esc>(00<esc>(s0p8.00h8.4v0s0b0t	USB1 2	
TH MICR 0Q 600	8.00/8.4	<esc>(00<esc>(s0p8.00h8.4v0s0b0t	USB1 3	
ABCDEFGHIJj i ç ³ ´ ¶ ¸ ¹ º » ¼ ½ ¾ # \$	10.00/10.0	<esc>(10<esc>(s0p10.00h10.0v0s0b104t	USB1 4	
OCRB				
TH MICR 600	8.00/8.0	<esc>(8M<esc>(s0p8.00h8.0v0s0b80t	USB1 5	
TH MICR	8.00/10.0	<esc>(8M<esc>(s0p8.00h10.0v0s0b100t	USB1 6	
TH MICR 600 Ent	8.05/10.0	<esc>(8M<esc>(s0p8.05h10.0v0s0b100t	USB1 7	
TH MICR 600 Ent2	8.00/10.0	<esc>(8M<esc>(s0p8.00h10.0v0s0b100t	USB1 8	
TH MICR-600 100	8.00/12.0	<esc>(100<esc>(s0p8.00h12.0v0s0b360t	USB1 9	
TYPEHAUS	0.46/20.0	<esc>(320<esc>(s0p0.46h20.0v0s0b24t	USB1 10	
© Copyright 2010. All rights Reserved.				

Internal Scalable and Bitmapped Fonts

Font	Pitch/Point	Escape Sequence	Font #	Font ID
Courier	Scalable	<esc>([] <esc>(s0p [] h0s0b4099t	INTERNAL 0	
CG Times	Scalable	<esc>([] <esc>(s1p [] v0s0b4101t	INTERNAL 1	
CG Times Bold	Scalable	<esc>([] <esc>(s1p [] v0s3b4101t	INTERNAL 2	
CG Times Italic	Scalable	<esc>([] <esc>(s1p [] v1s0b4101t	INTERNAL 3	
CG Times Bold Italic	Scalable	<esc>([] <esc>(s1p [] v1s3b4101t	INTERNAL 4	
CG Omega	Scalable	<esc>([] <esc>(s1p [] v0s0b4113t	INTERNAL 5	
CG Omega Bold	Scalable	<esc>([] <esc>(s1p [] v0s3b4113t	INTERNAL 6	
CG Omega Italic	Scalable	<esc>([] <esc>(s1p [] v1s0b4113t	INTERNAL 7	
CG Omega Bold Italic	Scalable	<esc>([] <esc>(s1p [] v1s3b4113t	INTERNAL 8	
Coronet	Scalable	<esc>([] <esc>(s1p [] v1s0b4116t	INTERNAL 9	
Clarendon Condensed	Scalable	<esc>([] <esc>(s1p [] v4s3b4140t	INTERNAL 10	
Univers Medium	Scalable	<esc>([] <esc>(s1p [] v0s0b4148t	INTERNAL 11	
Univers Bold	Scalable	<esc>([] <esc>(s1p [] v0s3b4148t	INTERNAL 12	
Univers Medium Italic	Scalable	<esc>([] <esc>(s1p [] v1s0b4148t	INTERNAL 13	

[] Pitch: 0.10 - 576 [] Symbol set [] Point size: 0.25 - 999.75
See your Printer User's Manual for more information.